



ARTISTRY - YH2 Series Ultra-Fine Indoor LED adopts the high-quality and high-density SMD LEDs as a display panel. It can make a fine pixel pitch LED screen of *any size by seamless splice*. It also fully meets the requirements for the application which needs seamless and high-quality image. Apart from its *high precise die-casting aluminum and positioning fixtures*, its cabinet is *convertible to curved display with different angles*, ensuring *seamless cabinet alignment*, delivering immersive visual experience which is the traditional LCD or DLP cannot make.

#### Application

- Video conference
- Command center
- TV broadcasting
- Security monitor
- Exhibition
- Public security
- Smart city

#### · Whisper-quiet Operation



#### · Aluminum Quality & Light Weight



#### · Light and Thin



#### · Front Accessibility.

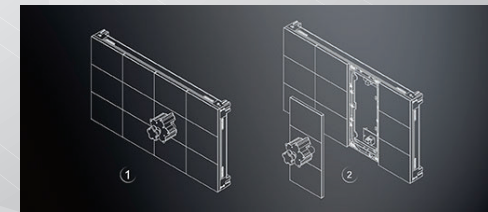

# ARTISTRY - YH2 Series Ultra Fine Indoor LED

Model	P1.27	P1.58	P1.9
<b>Optical Parameter</b>			
Pixel Pitch (mm)	1.27mm	1.58mm	1.9mm
Pixel Configuration	3 in 1 SMD	3 in 1 SMD	3 in 1 SMD
Pixel Density (Pixel/m <sup>2</sup> )	620000Pixel/m <sup>2</sup>	396800Pixel/m <sup>2</sup>	275500Pixel/m <sup>2</sup>
Viewing Angle (50% Brightness)(H/V)	160° / 160°	160° / 160°	160° / 160°
Brightness (cd/m <sup>2</sup> )	700cd/m <sup>2</sup>	700cd/m <sup>2</sup>	700cd/m <sup>2</sup>
Contrast Ratio	≥800:1	≥800:1	≥800:1
Color Temperature (k)	3500-9300k	3500-9300k	3500-9300k
Processing Depth (bit)	16bit	16bit	16bit
Refresh Rate (Hz)	≥1920Hz	≥1920Hz	≥1920Hz
Optimized Viewing Distance (m)	≥1.3m	≥1.6m	≥1.9m
<b>Structure Parameter</b>			
Module Size in Pixel (W × H)	120 × 90pixel	96 × 72pixel	80 × 60pixel
Module Size in mm (W × H)	152.4 × 114.3mm	152.4 × 114.3mm	152.4 × 114.3mm
Cabinet Size in Pixel (W × H)	480 × 270pixel	384 × 216pixel	320 × 180pixel
Cabinet Size in mm (W × H × D)	609.6 × 342.9 × 56mm	609.6 × 342.9 × 56mm	609.6 × 342.9 × 56mm
Cabinet Weight (kg/m <sup>2</sup> )	45.45kg/m <sup>2</sup>	45.45kg/m <sup>2</sup>	47.84kg/m <sup>2</sup>
IP Rating	IP30	IP30	IP30
<b>Operation Parameter</b>			
Maintenance		Front Access	
Operating Temperature (°C)		-10C~40C	
Operating Humidity (RH%)		10~90RH%	
Life Time (50% Brightness)(Hours)		≥100000Hours	
Max. Power Consumption (W/m <sup>2</sup> )		550W/m <sup>2</sup>	
Avg. Power Consumption (W/m <sup>2</sup> )		165W/m <sup>2</sup>	
<b>System Parameter</b>			
Video Signal Input		HDMI / DVI-D	



ARTISTRY - YH2系列超精细室内LED采用高品质及高密度SMD LED作为显示面板。它采用了自主研发的全压铸铝箱体，透过CNC精加工做到真正的无缝拼接及制作任何尺寸的LED屏幕，以满足需要无缝拼接和高质量图像的应用。除了高精度压铸铝和定位外，其箱体可转换为具有不同弧度的显示屏，确保箱体无缝对接，提供恍如身临其境的视觉体验，这是有别于传统LCD或DLP的。

#### 应用

- 视频会议
- 指挥中心
- 电视广播中心
- 安全监控中心
- 展览中心
- 公安中心
- 智慧型城市

#### · 静音操作



#### · 全压铸铝箱体，重量轻



#### · 超轻薄



#### · 前维护

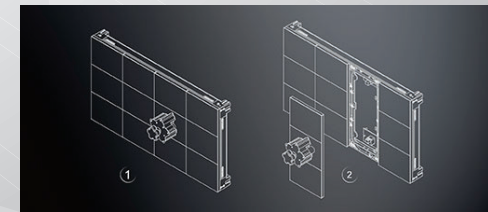

型号	P1.27	P1.58	P1.9
<b>光学参数</b>			
点间距(mm)	1.27mm	1.58mm	1.9mm
发光管类型	3 in 1 SMD	3 in 1 SMD	3 in 1 SMD
点密度(点/m <sup>2</sup> )	620000点/m <sup>2</sup>	396800点/m <sup>2</sup>	275500点/m <sup>2</sup>
视角(亮度为50%时)(水平/垂直)	160° / 160°	160° / 160°	160° / 160°
亮度(cd/m <sup>2</sup> )	700cd/m <sup>2</sup>	700cd/m <sup>2</sup>	700cd/m <sup>2</sup>
对比度	≥800:1	≥800:1	≥800:1
色温(k)	3500-9300k	3500-9300k	3500-9300k
处理深度(bit)	16bit	16bit	16bit
刷新率(Hz)	≥1920Hz	≥1920Hz	≥1920Hz
最佳观看距离(m)	≥1.3m	≥1.6m	≥1.9m
<b>结构参数</b>			
模块尺寸(W × H)(点)	120 × 90点	96 × 72点	80 × 60点
模块尺寸(W × H × D)(mm)	152.4 × 114.3mm	152.4 × 114.3mm	152.4 × 114.3mm
模组尺寸(W × H)(点)	480 × 270点	384 × 216点	320 × 180点
模组尺寸(W × H × D)(mm)	609.6 × 342.9 × 56mm	609.6 × 342.9 × 56mm	609.6 × 342.9 × 56mm
模组重量(kg/m <sup>2</sup> )	45.45kg/m <sup>2</sup>	45.45kg/m <sup>2</sup>	47.84kg/m <sup>2</sup>
防护等级	IP30	IP30	IP30
<b>操作参数</b>			
维护方式		前维护	
工作温度(℃)		-10℃~40℃	
工作湿度(RH%)		10~90RH%	
寿命(亮度为50%时)(小时)		≥100000小时	
最大功耗(W/m <sup>2</sup> )		550W/m <sup>2</sup>	
平均功耗(W/m <sup>2</sup> )		165W/m <sup>2</sup>	
<b>系统参数</b>			
视频信号输入		HDMI / DVI-D	